

Beamever

NOVA TAPE

Dot-free, flexible,
cuttable and dimmable tape.
Pre-wired tape, simple and
quick installation.

Easy to mount on smooth
surfaces thanks to high quality
3M tape at the back.

One BIN Only to ensure perfect
color consistency



Beamever



NOVA TAPE

- Almost dot-free itself, which offer you great freedom of choosing profile.
- High lumen and fancy looking by the unique design.
- Wide color temperature range for your option.
- Long lifespan and excellent in heat dissipation.
- Use COB chips in One BIN Only to ensure perfect color consistency.
- High CRI90 to present real color.

Product Benefits:

- Flexible, cuttable and dimmable LED strip.
- Easy to mount on smooth surfaces thanks to high quality 3M tape at the back.
- Pre-wired LED strip, simple and quick connection.

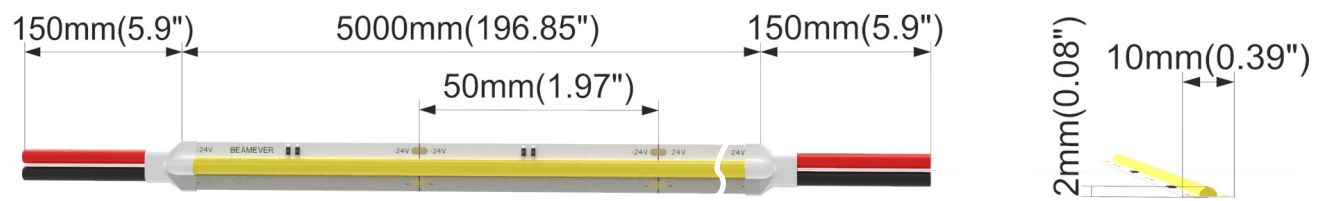

Electrical data

Voltage	DC24V (23.5V _{min} 24.5V _{max})
LED PIN Temperature	Max. 65°C /149°F
Storage Temperature	-25°C /-13°F _{min} 60°C /140°F _{max}
SMD Type	COB
LEDs/m	480LEDs/m
Efficacy (lm/W)	110lm/W@4000K
SDCM	3 (2700K, 3000K, 4000K)
CRI	Ra90
Max Current/LED	10.4mA@4.57W/ft
Cut Increments	50mm/1.97"
Waterproof Rate	IP20
Warranty	5 Years

Lumen/ft	1.52W	3.05W	4.57W
2700K	155	290	421
3000K	168	305	451
3500K	180	332	457
4000K	191	337	488
6500K	183	335	494
Max. Run Length(ft)	16.40	16.40	16.40

Important notice

-The given data are typical values due to the tolerances of the production process and the electrical components, values for light output and electrical power can vary up to 10%.

Indoor

Life span > 54000H

One Bin Only

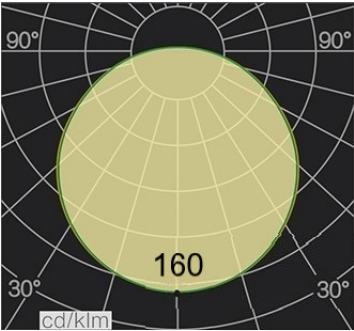

UL

CE

RoHS

REACH

Order code

SERIES NAME	COLOR	LENGTH	POWER
NOVA TAPE	27= 2700K	1.97"-1968.50"	152=1.52W
	30= 3000K		305=3.05W
	35= 3500K		457=4.57W
	40=4000K		
	65=6500K		

Example 1:
NOVA TAPE-27-196.85-152:
NOVA TAPE, 2700K, 196.85"/reel,
1.52W/ft.

Example 2:
NOVA TAPE-30-196.85-305:
NOVA TAPE, 3000K, 196.85"/reel,
3.05W/ft.

Accessories

Art.#	Description	Picture	Art.#	Description	Picture
C0011	Connector for Strip to strip connection, IP20		T0001	VHB 3M adhesive tape	
C0012	Connector for Strip to strip connection, IP20		XLG-150-24-A	PSU 24V/150W IP67, Non-dimmable, White, 100-305V supply	
MF001	Male and Female connector, IP20		ELG-150-24B	PSU 24V/150W IP67, 3 in 1 dimming function, White, 100-305V supply	
MF002	Male and Female DC connector, IP44		ELG-150-24DA	PSU 24V/150W IP67, DALI control technology, White, 100-305V supply	

Wiring connection

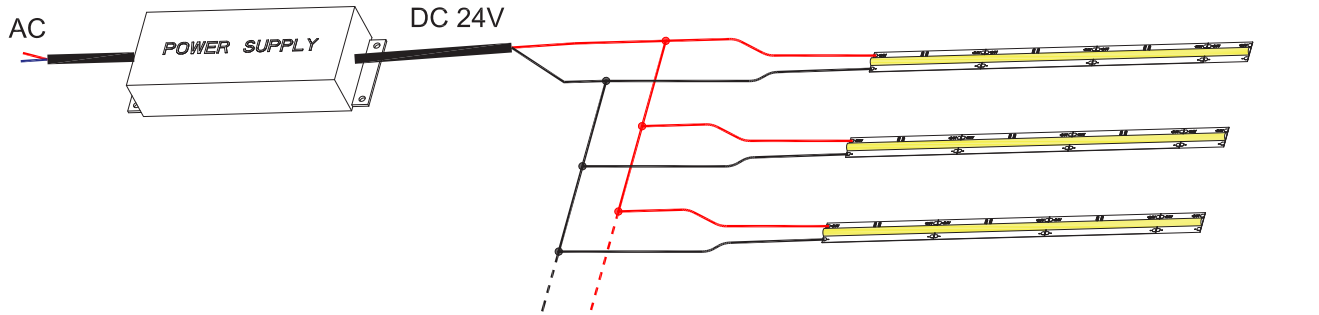

Application

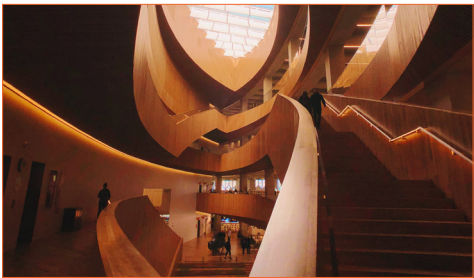

Where to use the product?

NOVA TAPE is our most popular COB strip model made with the best materials and the most meticulous quality control. The perfect combination of dot-free lighting and incredible pricing made it an instant star for indoor lighting projects. Here at BEAMEVER, we make sure that you can have both premium lighting and excellent budget.

Suitable applications can be residential areas, corporate offices, theme parks, meeting rooms, shopping malls, and so on. Where interior lighting is needed, where our NOVA TAPE can come into use.



Beamever

Address: 100 N Howard St Ste R,
Spokane, WA, 99201-0508 USA
Tel: 323-5104660
info@beamever.com
www.beamever.com